

**RESOLUTION OF THE MAYOR AND BOARD OF ALDERMEN OF THE  
CITY OF SOUTHAVEN, MISSISSIPPI DESIGNATING THE SNOWDEN DISTRICT**

**WHEREAS**, the City of Southaven ("City") was incorporated and established on April 15, 1980; and

**WHEREAS**, since the inception and incorporation of the City, the City has grown and expanded at a tremendous rate and the City's eastern portion now includes Getwell Road, specifically Getwell Road from Goodman Road south to Church Road; and

**WHEREAS**, the area noted above, commonly known as the Getwell Road Corridor is special and vital to the growth and well-being of the City as it includes successful business, high-end shopping, restaurants, an amphitheater, which hosts Grammy award winners and the nicest municipal park and baseball complex in the State of Mississippi; and

**WHEREAS**, the City Mayor and Board now desire to designate that area commonly referred to as the Getwell Road Corridor, specifically Getwell Road from Goodman Road south to Church Road, and as more fully and particularly defined in the map attached hereto as Exhibit A and incorporated as part of this Resolution, as the "Snowden District"; and

**WHEREAS**, the City Mayor and Board appreciate and acknowledge the importance and necessity of a thriving "Snowden District" for all citizens in the City; and

**WHEREAS**, the City Mayor and Board take pride in the "Snowden District" and desire to continue to sustain and improve the "Snowden District" by attracting unique eateries, park and recreational activities and private commercial and business investment; and

**NOW, THEREFORE, BE IT ORDERED** by the Mayor and Board of Aldermen of the City of Southaven, Mississippi as follows, to wit:

1. That the Getwell Road Corridor, specifically Getwell Road from Goodman Road south to Church Road, and as more fully and particularly defined in the map attached hereto as Exhibit A and incorporated as part of this Resolution, be designated as the "Snowden District" of the City of Southaven.
2. That in order to continue and maintain the aesthetics, entertainment aspect, parks and recreational areas, unique character and upscale nature of the "Snowden District" the City's officials shall continue to enforce, adhere and comply with the City's Comprehensive Plan and relevant zoning and planning requirements and high standards for development within the "Snowden District."
3. The Mayor and his designees are authorized to take any and all action, including preparing and distributing information about the "Snowden District" and the hanging of the Snowden District Banners, throughout the Snowden District, to effectuate the intent of this Resolution.

Following the reading of the foregoing resolution, Alderman Flores made the motion to adopt the Resolution and Alderman Ferguson seconded the motion for its adoption. The Mayor put the question to a roll call vote and the result was as follows:

Alderman William Brooks	YES
Alderman Kristian Kelly	YES
Alderman Shirley Beshears	YES
Alderman George Payne	YES
Alderman Joel Gallagher	YES
Alderman Scott Ferguson	YES
Alderman Raymond Flores	YES

RESOLVED AND DONE, this 17th day of February, 2015.



DARREN MUSSELWHITE, MAYOR

ATTEST:



CITY CLERK



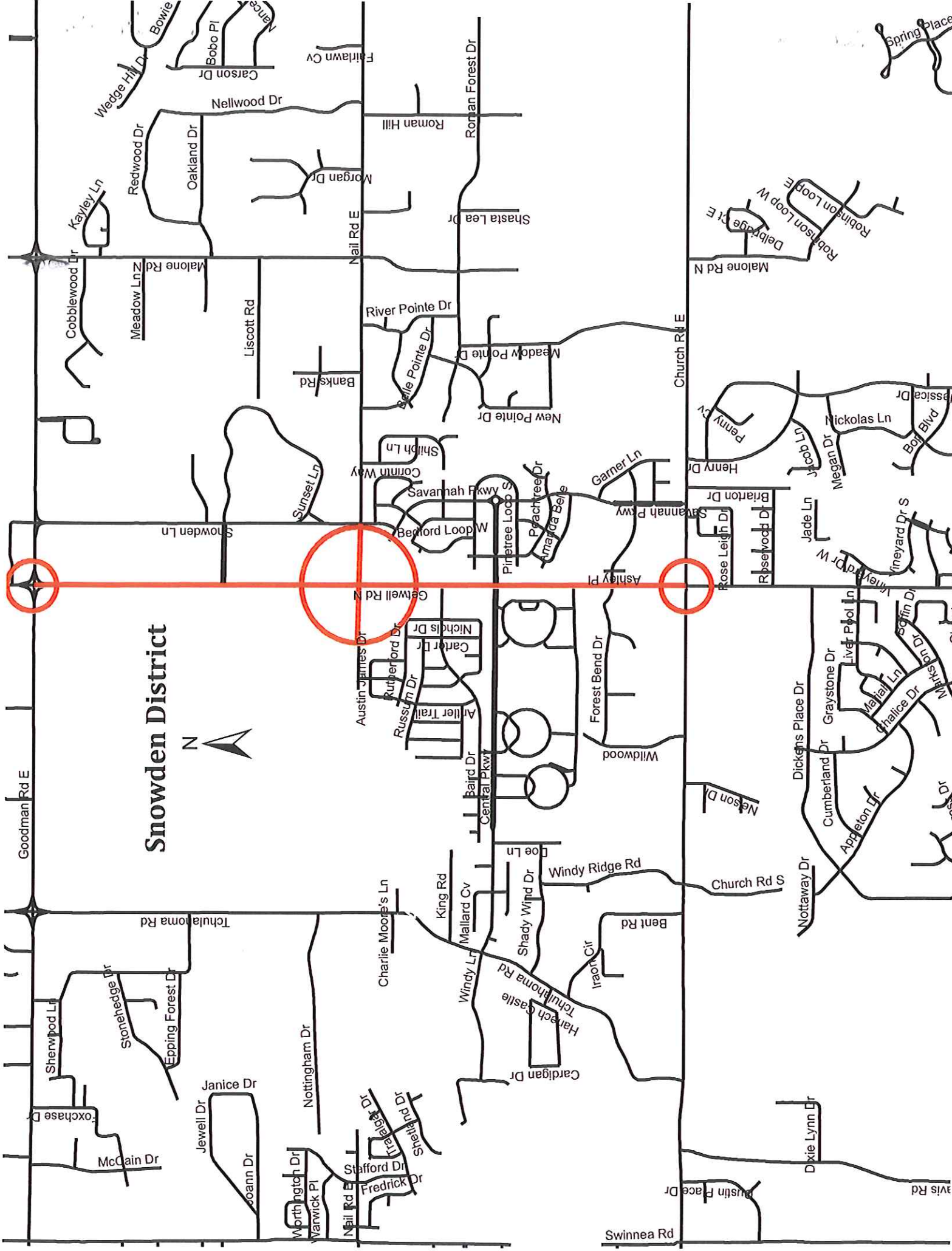

# Snowden District



Spring Place

1000

Wis Rd

1000